

Lead Screw

Linear actuation for positioning tasks

For combination with Stepper Motors

Series M2 x 0,2 x L1

Ordering information	L1 (mm) =	15	25	28/30	Custom
Order code (no bearing tip)		M2x15	M2x25	M2x30	M2xL1*
Order code (with bearing tip)		M2x15T	M2x25T	M2x28T	M2xL1*T
Nominal diameter	2,0				mm
Pitch	0,2				mm
Material	Stainless steel				

* For custom length, please inquire with your point of sales

For combination with Stepper Motors AM0820, AM1020, DM1220, AM1524

Important notes

The thrust curves include already a safety factor for the use of the stepper motor. Please read the "Technical information" for a better understanding of the curves.

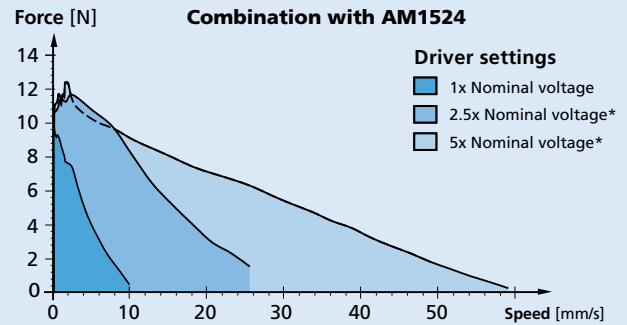
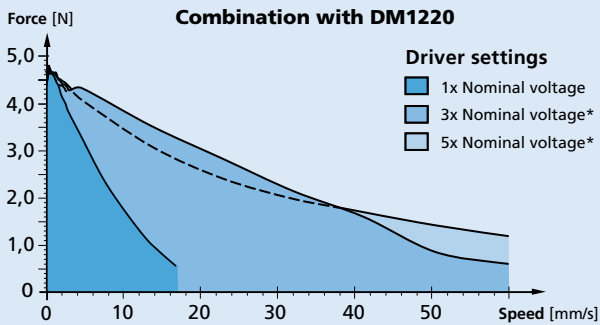
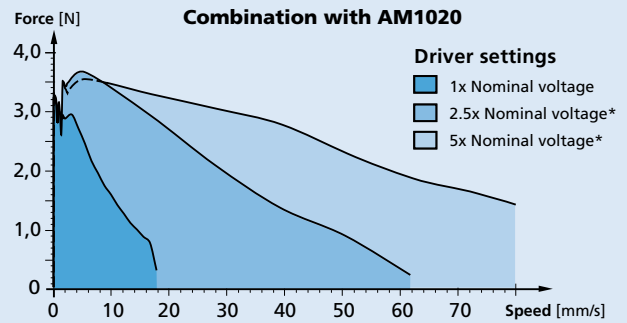
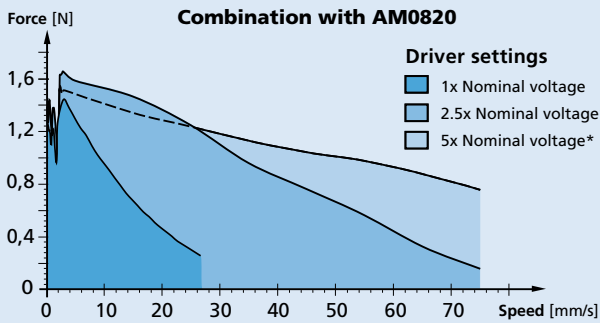

* Current limited to its nominal value

Dimensional drawing

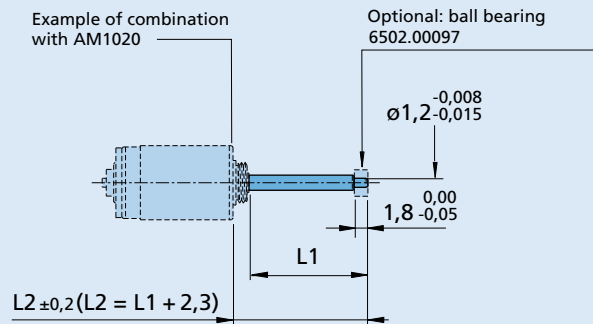
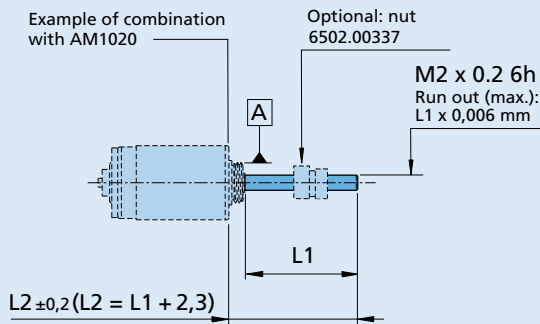

M2,0 x 0,2 x L1

Version with bearing tip
M2,0 x 0,2 x L1 T

Lead Screw

Optional nuts and bearings

Options

For M1,2 x 0,25 Lead screws

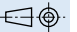
Scale 2:1 

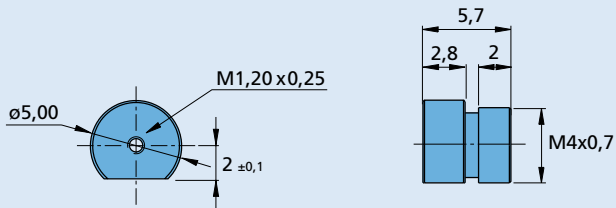

Nut Part No. 6502.00366, Self-lubricating synthetics material

For M1,6 x 0,35 Lead screws

Scale 2:1 

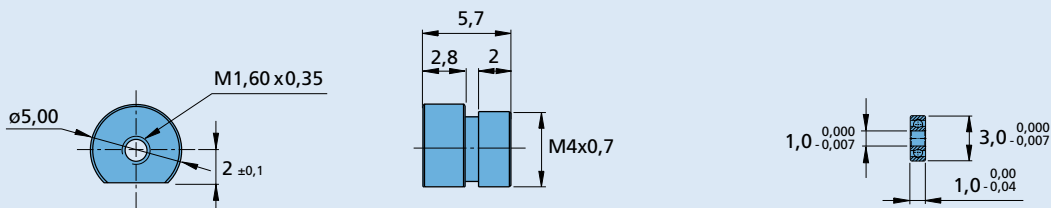

Nut Part No. 6502.00370, Self-lubricating synthetics material

Bearing for leadscrew tip Part No. 6502.00102

For M2,0 x 0,2 Lead screws

Scale 2:1 

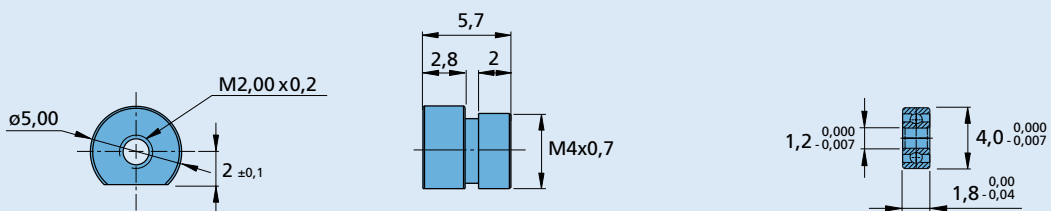

Nut Part No. 6502.00337, Self-lubricating synthetics material

Bearing for leadscrew tip Part No. 6502.00097

For M3,0 x 0,5 Lead screws

Scale 2:1 

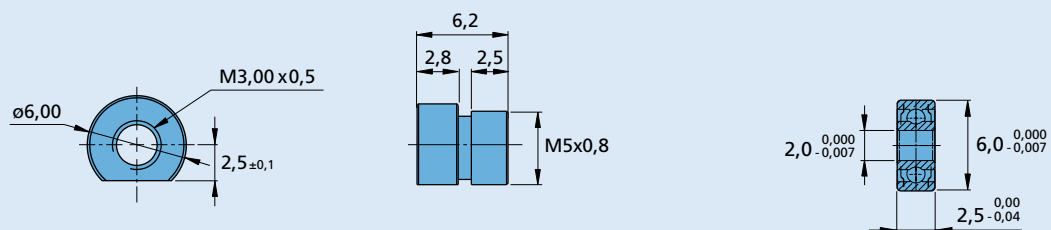

Nut Part No. 6502.00323, Self-lubricating synthetics material

Bearing for leadscrew tip Part No. 6502.00103